

1. Technical Specifications

Sensor Model	PIR detection
HIR23/D2/H	Installation height: 15m (forklift) 12m (person)
	Detection range (Ø): 24m
Lux reading range	<1000 lux
Detection angle	360°
Operating voltage	9.5-22.5VDC
Consumption DALI	Max. 10 mA (no LED)
BUS current	Max. 12 mA (with LED)
Identify device	Red LED flashes 15S
Warming-up	5s
Operation temperature	Ta: -20°C ~ +50°C
IP rating	IP20

2. Installation

Wire Preparation

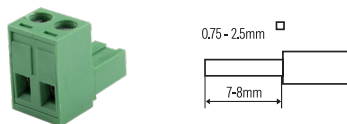

Pluggable screw terminal. It is recommended to make connections to the terminal before fitting to the sensor.

- 1.200 metres (total) max. for 1mm² CSA (Ta = 50 °C)
- 2.300 metres (total) max. for 1.5mm² CSA (Ta = 50 °C)

Mechanical Structure & Dimensions

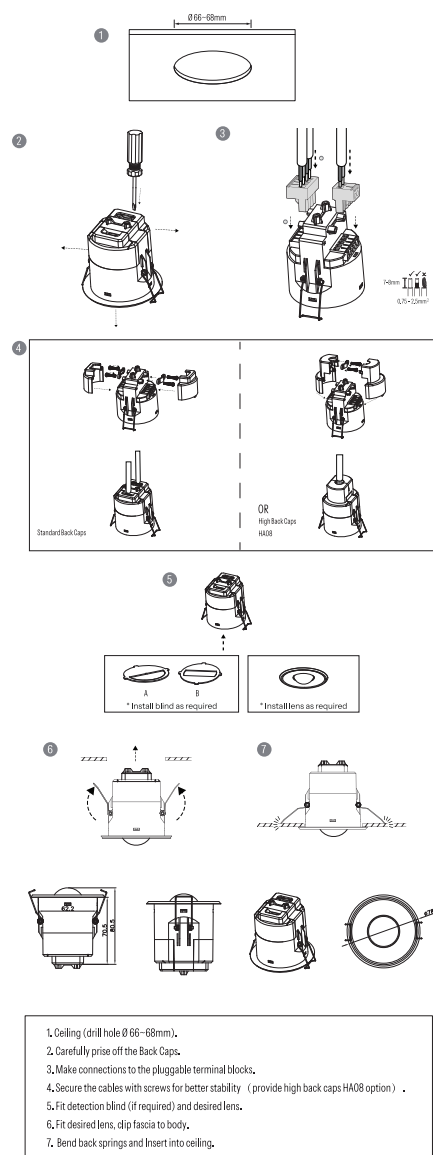

1. Ceiling (drill hole Ø 66-68mm).
2. Carefully prise off the Back Caps.
3. Make connections to the pluggable terminal blocks.
4. Secure the cables with screws for better stability (provide high back caps HA08 option).
5. Fit detection blind (if required) and desired lens.
6. Fit desired lens, clip fascia to body.
7. Bend back springs and Insert into ceiling.

Wiring Diagram

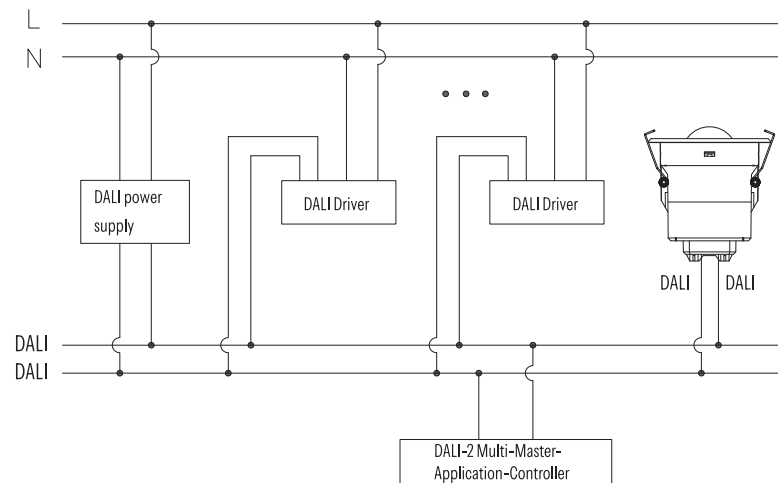

—This product should be installed by a qualified electrician.

Note: HIR23/D2/H has been used as DALI-2 input device to only report DALI instance (light sensor instance and motion sensor instance) to DALI-2 application controller, who is the "main brain" to process the data communication between input devices and the control gear and assign different function.

3. Detection Pattern & Optional Accessories

HIR23/D2/H (High-bay)			
HIR23/D2/H: High-bay lens detection pattern for forklift @ Ta = 20°C (Recommended ceiling mount installation height 10m-15m)			
	Mount height	Tangential (A)	Radial (B)
A: Tangential movement	10m	max 380m ² (Ø = 22m)	max 201m ² (Ø = 16m)
	11m	max 452m ² (Ø = 24m)	max 201m ² (Ø = 16m)
B: Radial movement	12m	max 452m ² (Ø = 24m)	max 201m ² (Ø = 16m)
	13m	max 452m ² (Ø = 24m)	max 177m ² (Ø = 15m)
	14m	max 452m ² (Ø = 24m)	max 133m ² (Ø = 13m)
	15m	max 452m ² (Ø = 24m)	max 113m ² (Ø = 12m)



HIR23/D2/H: High-bay lens detection pattern for **single person** @ Ta = 20°C
 (Recommended ceiling mount installation height **2.5m-12m**)

A: Tangential movement

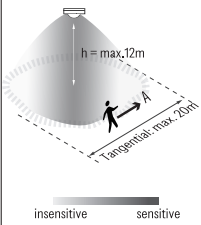

B: Radial movement



Mount height	Tangential (A)	Radial (B)
2.5m	max 50m ² (Ø = 8m)	max 7m ² (Ø = 3m)
6m	max 104m ² (Ø = 11.5m)	max 7m ² (Ø = 3m)
8m	max 154m ² (Ø = 14m)	max 7m ² (Ø = 3m)
10m	max 227m ² (Ø = 17m)	max 7m ² (Ø = 3m)
11m	max 269m ² (Ø = 18.5m)	max 7m ² (Ø = 3m)
12m	max 314m ² (Ø = 20m)	max 7m ² (Ø = 3m)

Optional Accessory --- Ceiling/Surface Metal Mount Box: HA09/W, HA09/B, HA09/G

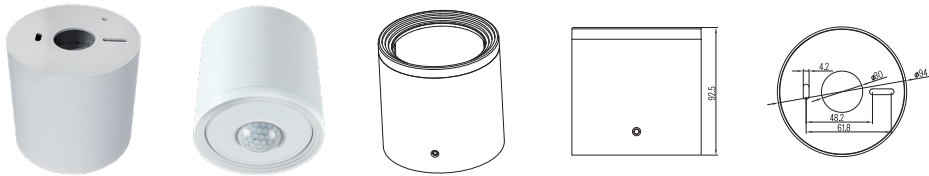

Optional Accessory --- HA08

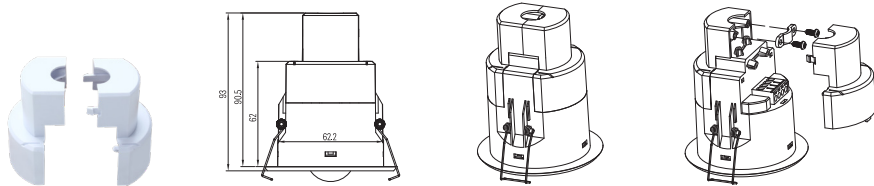

*Note: Optional Accessory HA09 & HA08 can not be used together.

Optional Accessory --- Blind Insert for Blocking Certain Detection Angles

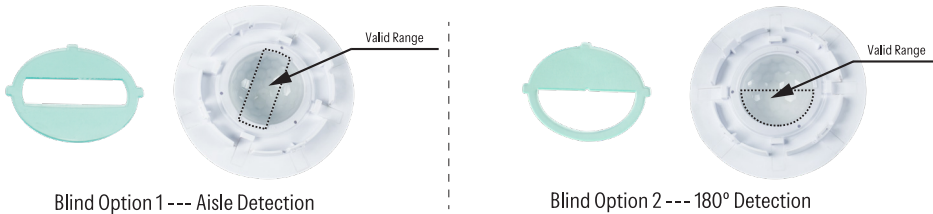

Big and small silicon gasket used to make IP54 degree protection (mounted into HA09 housing for ceiling mount)

Small silicon water-proof gasket dimension (size:mm)

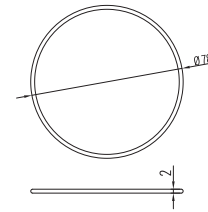

Big silicon water-proof gasket dimension (size:mm)

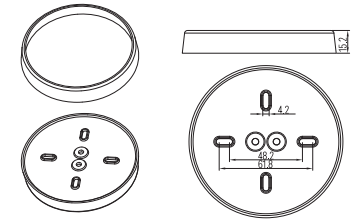

4. Additional Information / Documents

1. Regarding precautions for PIR Sensors installation and operation, please kindly refer to www.hytronik.com/download → knowledge → PIR Sensors - Precautions for Product Installation and Operation
2. Data sheet is subject to change without notice. Please always refer to the most recent release on [www.hytronik.com/products/Motion Sensors](http://www.hytronik.com/products/Motion%20Sensors) → Stand-alone Sensors
3. Regarding Hytronik standard guarantee policy, please refer to www.hytronik.com/download → knowledge → Hytronik Standard Guarantee Policy