

# Installation and Instruction Manual

# HYTRONIK®

True Occupancy Sensor with Bluetooth® 5.0 SIG Mesh

HBMW29/PRO

DALI-2 output & Low-bay

## 1. Technical Specifications

Operation frequency	2.4 GHz - 2.483 GHz
Transmission power	4 dBm
Range (Typical indoor)	10-30m
Protocol	Bluetooth® 5.0 SIG Mesh
Operating voltage	220-240VAC 50/60Hz
Stand-by power	<1W
Output	I guaranteed : 30mA I max : 50mA U rated : 15VDC
Sensor principle	Occupancy Motion detection
Ceiling-mounted Detection range (Max.)*	Installation Height : 3m Detection Range (Ø) : 8m
Wall-mounted Detection range (Max.)*	Installation Height : 3m Detection Range : 6m
Detection angle	360°
Operation temperature	Ta: -25°C - +60°C
IP rating	IP20/IP54

## 2. Download the App

Free App for set-up and commissioning

iOS

for iOS

for Android

Smartphone app for both iOS & Android platform

---

for iPad

Koolmesh Pro app for iPad

---

Web

for Web

Web app/platform: [www.iot.koolmesh.com](http://www.iot.koolmesh.com)

## 3. Installation

Mechanical Structure & Dimensions

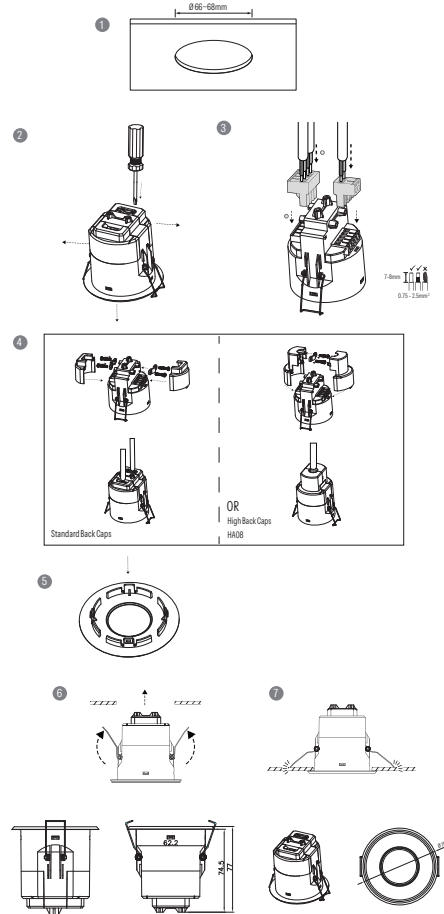

1. Ceiling (drill hole  $\phi 66-68\text{mm}$ )
2. Carefully prise off the cable clamps.
3. Make connections to the pluggable terminal blocks.
4. Secure the cables with screws for better stability (provide high back caps HA08 option).
5. Fit desired lens.
6. Clip fascia to body.
7. Bend back springs and insert into ceiling.

## Wire Preparation

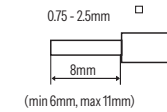

Pluggable screw terminal. It is recommended to make connections to the terminal before fitting to the sensor.

- 1. 200 metres (total) max. for 1mm<sup>2</sup> CSA (Ta = 50°C)
- 2. 300 metres (total) max. for 1.5mm<sup>2</sup> CSA (Ta = 50°C)

## Wiring Diagram

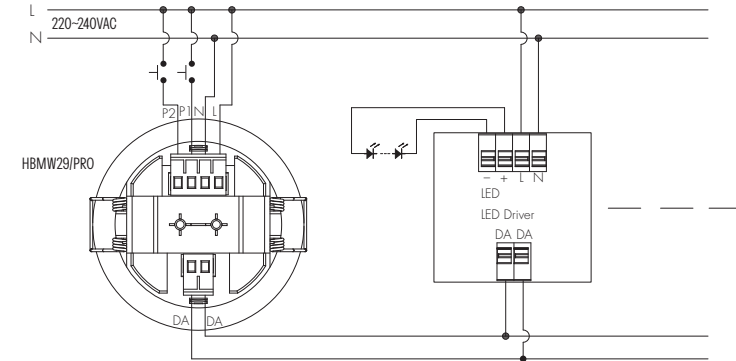

---This product should be installed by a qualified electrician.

## Sensor Installation and Commissioning Guidelines

### A. Installation Preparation

1. Make sure the room is empty with no moving people or machinery when first powered up for 1 minute.
2. There is a 20-second warm-up time for the sensor. Please do the commissioning after warm-up.
3. When the sensor is powered off, repeat the initial steps once it's re-powered

### B. Sensor Placement

1. The distance between sensors should be at least 3 meters.
2. Sensors should not directly face sources of microwave interference, such as other microwave sensors, microwave ovens, or wireless routers. Maintain a distance of at least 3 meters.
3. The installation environment should avoid object vibrations, strong airflows, curtain movements, water flow in pipes, window glass vibrations, and wind-induced movements of metal roofs. Aim for a stable environment with minimal variables.
4. The sensor is highly sensitive and suitable for stable and quiet environments like offices and hotels, but not for industrial settings.

### C. Sensor Operation

1. Movements within 0.3 meters of the sensor, such as waving an arm, might not trigger the sensor, as it will identify and filter out such large movements.
2. In test mode, a red LED will flash when the sensor is triggered. There are no visual indications in normal mode.
3. If the sensor is too sensitive, use the HRC-12 remote controller to lower the sensitivity.
4. Avoid accidentally entering semi-auto mode.
5. Pay attention to the daylight sensor threshold value, which needs to be adjusted according to the installation environment.

## 4. Detection Pattern & Optional Accessories

### Placement Guide and Typical Range

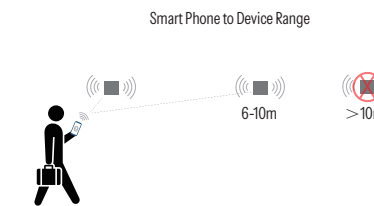

The smart device with the App installed will have a typical range of 10m, but varies from device to device. During commissioning, the installer will need to be in range of the devices when searching for devices to add to the network.

Once the devices have been added to the network via the App, the devices will start communicating within the wireless mesh. This means that once the network is complete, all devices are accessible from the smart device when in a 20m range of a single point.

## Detection Pattern

### Ceiling-mounted application

Installation height: 3m

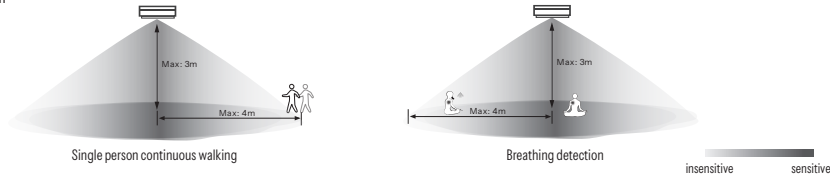

\*When it's in breathing & true occupancy detection mode and in sitting situation, facing to sensor directly will have a better detection range than 90 degrees side facing to sensor.

### Wall-mounted application

Installation height: max.3m

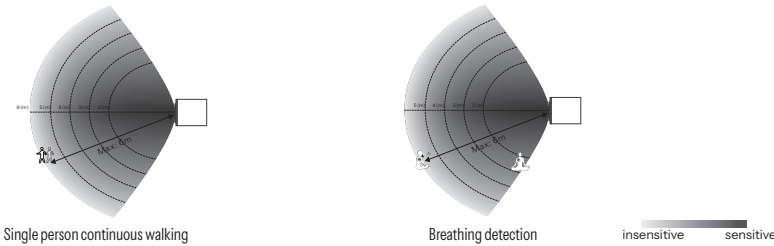

\*When it's in breathing & true occupancy detection mode and in sitting situation, facing to sensor directly will have a better detection range than 90 degrees side facing to sensor.

## Optional Accessory --- Ceiling/Surface Metal Mount Box: HA09/W, HA09/B, HA09/G

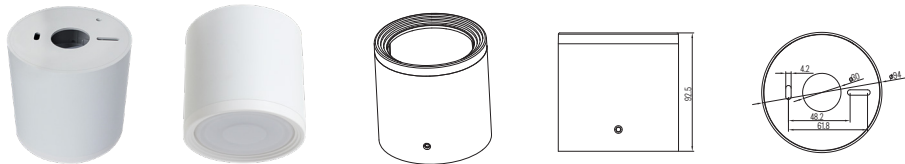

## Optional Accessory --- HA08

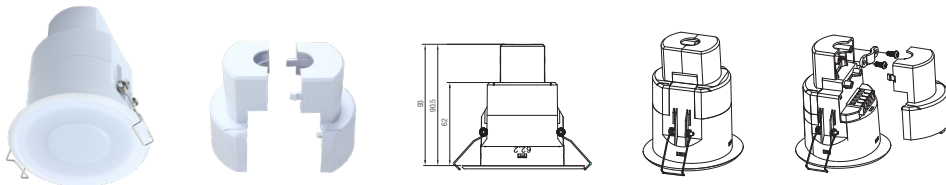

\*Note: Optional Accessory HA09 & HA08 can not be used together.

## Big and small silicon gasket used to make IP54 degree protection (mounted into HA09 housing for ceiling mount)

### Small silicon water-proof gasket dimension(size:mm)

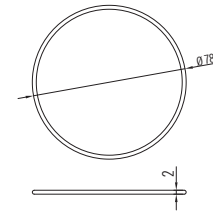

### Big silicon water-proof gasket dimension(size:mm)

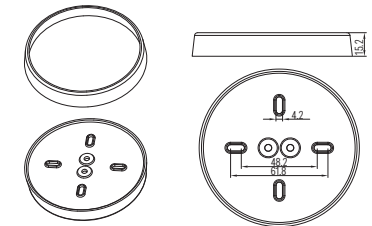

## 5. Dimming Interface Operation Notes

Switch-Dim

The provided Switch-Dim interface allows for a simple dimming method using commercially available non-latching (momentary) wall switches. Detailed Push switch configurations can be set on Koolmesh app.

Switch Function	Action	Descriptions
Push switch	Short press (<1 second) * Short press has to be longer than 0.1s, or it will be invalid.	- Turn on/off - Recall a scene - Turn on only - Quit manual mode - Turn off only - Do nothing
	Double push	- Turn on only - Turn off only - Recall a scene - Quit manual mode - Do nothing
	Long press (≥1 second)	- Dimming - Colour tuning - Do nothing
Sensor-link (VFC signal only)	/	- Upgrade a normal on/off motion sensor to a Bluetooth controlled motion sensor
Emergency Self-Test Function	Short press (<1 second) * Short press has to be longer than 0.1s, or it will be invalid.	- Start Self test (Monthly) - Stop Self test - Start Self test (Annually) - Invalid
	Long press (≥1 second)	- Start Self test (Monthly) - Stop Self test - Start Self test (Annually) - Invalid
Fire Alarm (VFC signal only)	Refer to <b>Koolmesh</b> App User Manual V2.1	- Able to connect the Fire Alarm system - Once the fire alarm system is triggered, all the luminaries controlled by the Push Switch will enter the preset scene (normally it's full on), after the fire alarm system gives the ending signal, all the luminaries controlled by this Push Switch will revert back to normal status.

## 6. Additional Information / Documents

- To learn more about detailed product features/functions, please refer to [www.hytronik.com/download](http://www.hytronik.com/download) → knowledge → Introduction of App Scenes and Product Functions
- Regarding precautions for Bluetooth product installation and operation, please kindly refer to [www.hytronik.com](http://www.hytronik.com) → download/knowledge → Bluetooth Products - Precautions for Product Installation and Operation
- Data sheet is subject to change without notice. Please always refer to the most recent release on [www.hytronik.com/products/bluetooth-technology](http://www.hytronik.com/products/bluetooth-technology) → Bluetooth Sensors
- Regarding Hytronik standard guarantee policy, please refer to [www.hytronik.com/download](http://www.hytronik.com/download) → knowledge → Hytronik Standard Guarantee Policy